

**USBXCHANGE<sup>TM</sup>**  
**QUICK INSTALL**

**USBXCHANGE<sup>TM</sup>**  
**KURZANLEITUNG**

**USBXCHANGE<sup>TM</sup>**  
**INSTALLATION RAPIDE**

**USBXCHANGE<sup>TM</sup>**  
**INSTALLAZIONE RAPIDA**

**INSTALACIÓN RÁPIDA DE**  
**USBXCHANGE<sup>TM</sup>**



## Installing on a PC

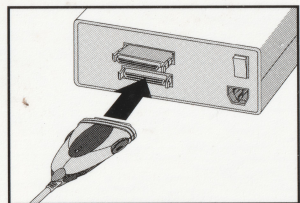

STEP 1

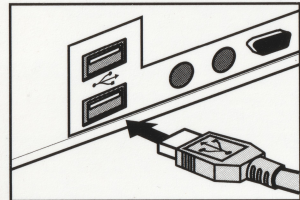

STEP 4

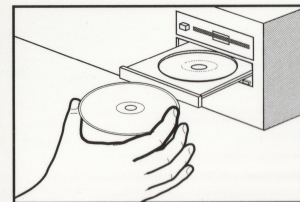

STEP 5

1. Connect the USBXchange to your SCSI device(s). Depending on the SCSI device connector type, you can either attach the SCSI connector of the USBXchange directly to your SCSI device, or you may require an additional cable or converter. See the USBXchange User's Guide for more information about connecting multiple SCSI devices.

2. Power on the SCSI device(s).

3. After making the connection, if the computer is not powered up, then power it up now.

4. Connect the USB connector to the USB port on your computer or external USB hub.

Note: Adaptec recommends that you connect the USBXchange directly to a USB port on your computer. If you must connect through a USB hub, please make sure that you only use a self-powered hub.

5. Insert the USBXchange CD into the CD-ROM/DVD-ROM drive to install the driver software and follow the instructions on the screen.

## Installing on a Macintosh®

1. Power up your Macintosh and insert the USBXchange CD into the CD-ROM/DVD-ROM drive.
2. Double-click on the USBXchange installer application and follow the instructions on the screen.
3. After installation is complete, restart your Macintosh.

4. Connect the USBXchange to your SCSI device.

Depending on the SCSI device connector type, you can either attach the SCSI connector of the USBXchange directly to your SCSI device, or you may require an additional cable or converter. See the USBXchange User's Guide for more information.

5. Power on the SCSI device(s).

6. Connect the USB connector to the USB port on your computer or external USB hub.

Note: Adaptec recommends that you connect the USBXchange directly to a USB port on your computer. If you must connect through a USB hub, please make sure that you use only a self-powered hub.

7. After installation, USBXchange defaults to non-Mass Storage mode. To connect Mass Storage devices, use the USBXchange Switcher Control Panel. Please refer to the USBXchange User's Guide for more information on using USBXchange Switcher.

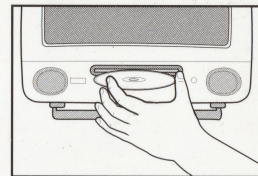

STEP 1

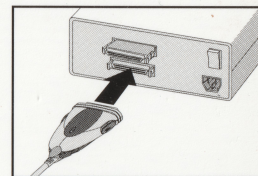

STEP 4

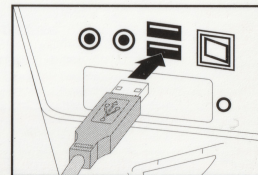

STEP 6

## Installing USBXchange

This Quick-Install guide briefly covers instructions for installing your USBXchange. This guide assumes you have a basic knowledge of using your computer, as well as SCSI and USB devices. For more detailed information, refer to the complete Adaptec USBXchange User's Guide included on your USBXchange CD. Adaptec recommends you read the User's Guide prior to operating your USBXchange.

Note: The USBXchange receives its electrical power from either an attached SCSI device or, if not available, the adapter switches automatically to receive power from the USB bus. In some rare cases, you may need to use an optional DC power supply. See the User's Guide and the ReadMe file on your CD for more information.

### Attention!

Adaptec, Inc. licenses the enclosed software to you only upon the condition that you accept all of the terms of the respective License Agreements that are included in the documentation accompanying this software. Please read the terms carefully before opening this package, as opening it will indicate that you accept these terms. If you do not agree to any of the terms of the License Agreements, please do not use the software. In that event, promptly return this package unopened, and your money will be refunded.

P/N 1866600EU

v1.1

REV A



Copyright 2000 Adaptec, Inc. All rights reserved. Adaptec, the Adaptec logo, and USBXchange are trademarks of Adaptec, Inc., which may be registered in some jurisdictions. Macintosh is a registered trademark of Apple Computer, Inc., used under license. All other trademarks used are owned by their respective owners.

Printed in Singapore

P/N 512616-00EU Rev C



# USBXCHANGE™

## CD Contents:

- Macintosh® software
- PC software
- Electronic User's Guide
- Adobe Acrobat

## Contenu du CD :

- Logiciel pour Macintosh®
- Logiciel pour PC
- Guide de l'utilisateur  
(version électronique)
- Adobe Acrobat

## Inhalt der CD:

- Macintosh®-Software
- PC-Software
- Online-Benutzerhandbuch
- Adobe Acrobat

## Contenuto del CD:

- Software per Macintosh®
- Software per PC
- Guida dell'utente  
in formato elettronico
- Adobe Acrobat



## Contenido del CD:

- Software para Macintosh®
- Software para PC
- Guía del usuario electrónica
- Adobe Acrobat



Copyright 2000 Adaptec, Inc. All rights reserved. Adaptec, the Adaptec logo, and USBXchange are trademarks of Adaptec, Inc., which may be registered in some jurisdictions. Macintosh is a registered trademark of Apple Computer, Inc. used under license. All other trademarks used are owned by their respective owners.

Made in Singapore